

Surface-mounted luminaire - Silky matt MIRO® parabolic louvres - direct distribution

Sheet steel housing suitable, rectangular cross section; suitable for use in clean rooms and clean room areas per DIN 14644-1; manufactured per IPA provisions, as well as the directives for quality assurance GMP (Good Manufacturing Practice); Housing colour traffic white RAL 9016; Direct light distribution using reflectivity-enhanced MIRO® aluminium parabolic louvres, silk-matt anodised, for computer workstations, omnidirectional glare reduction according to the current DIN EN 12464-1 standard With clear cover made of laminated safety glass; Integrated LED driver design.. Electrical connection and connection of control cable using 5-pole connection terminal with plug-in contacts; Luminous flux in emergency light mode 10287 lm. The aduna clean room luminaire is suitable for direct voltage (0/50Hz), emergency luminaires must have additional marking. Suitable for air purity class ISO 14644-1 Class 2 with excellent to very good results in terms of microbial metabolic potential and chemical resistance.

## CHARACTERISTICS

|                               |   |
|-------------------------------|---|
| Order number                  | 62154016660   |
| EAN number                    | 4020863450527   |
| Commodity code                | 94051190  |
| Certification mark            | IP 65, Protection class I, VDU 65° < 1000, F, D, Clean room, HACCP<br>DIN10500/Food/IFS/BRC, Indoor, CE |
| Impact resistance (IK rating) | IK07 (-20°C bis 35°C)   |
| Ambient temperatur            | ta -20°C to 35°C  |
| Special properties            | Ready for IoT   |
| Warranty period               | 7 years   |

## ELECTRICAL ENGINEERING

|                                      |  |
|--------------------------------------|--|
| Controller                           | Electronic driver DALI2 (2 pcs.)                           |
| System output                        | 100W   |
| Mains voltage                        | 230V/50Hz  |
| Circuit breakers (inrush current)    | 13 pieces/B10, 24 pieces/B16, 25 pieces/C10, 40 pieces/C16 |
| Energy efficiency class/light source | D  |

## LIGHTING TECHNOLOGY

|   |  |
|---|--|
| Placement                                     | LED, Colour rendering/Light colour<br>CRI ≥ 90 / 4000K                       |
| Colour tolerance (MacAdam)                    | 3SDCM  |
| Photobiological safety (Luminaire)            | RG0  |
| Nominal luminous flux                         | 10287lm  |
| Nominal luminous flux-emergency lighting mode | 10287lm  |
| LED service life                              | 68000h L80/B10 (Tq 35°C), 80000h L80/B10 (Tq 25°C), 37000h L90/B10 (Tq 25°C) |
| Luminaire luminous efficiency                 | 103lm/W  |
| UGR lat./long.                                | 14.0 / 18.0  |

## MECHANICS

|                      |   |
|----------------------|---|
| Housing colour       | traffic white RAL 9016  |
| Dimensions (LxWxDxH) | 1473mm x 340mm x 75mm   |
| Ceiling system       | cut-out ceilings [AD]   |
| Weight (net)         | 17kg  |
| Cable entry KE (X/Y) | 65mm/150mm  |
| Type of installation | Ceiling-mounted single installation,<br>Ceiling-mounted trunking installation,<br>Installation in clean room ceilings, Ceiling installation individual mounting |

## DEEP-LINK

<https://www.regiolux.de/en/article/62154016660>

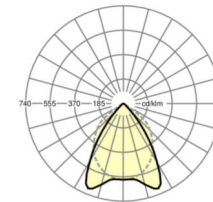
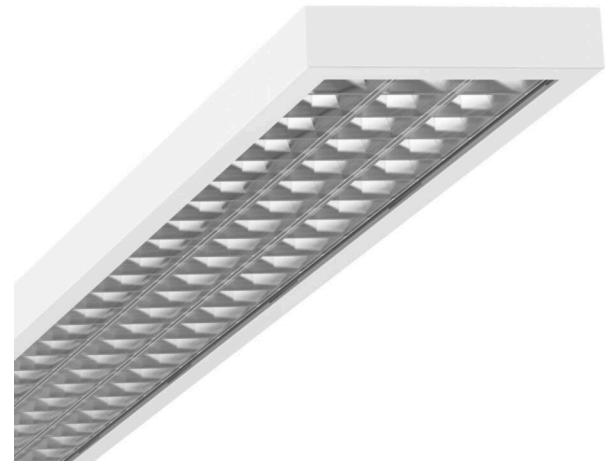

|                |                 |
|----------------|-----------------|
| Reference      | LED 10300lm 940 |
| ηLB            | 100 %           |
| Φ ↓/↑          | 100 % / 0 %     |
| UGR lat./long. | 14.0 / 18.0     |
| VDU            | 65° < 1000cd/m² |

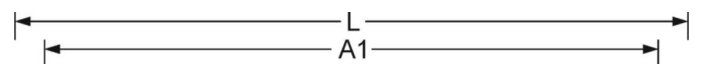
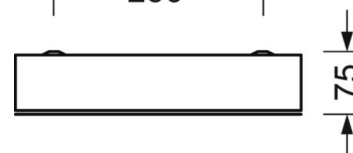
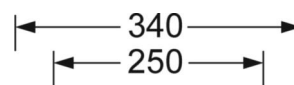

## Dimensions

|    |         |  |
|----|---------|--|
| L  | 1473 mm | Length   |
| B  | 340 mm  | Width  |
| H  | 75 mm   | Height   |
| A1 | 1380 mm | Mounting distance single mounting                                  |
| A3 | 93 mm   | Mounting distance between luminaires in a light run arrangement    |
| X  | 65 mm   | Distance cable infeed to the center of the luminaire on the X-axis |
| Y  | 150 mm  | Distance cable infeed to the center of the luminaire on the Y-axis |

